

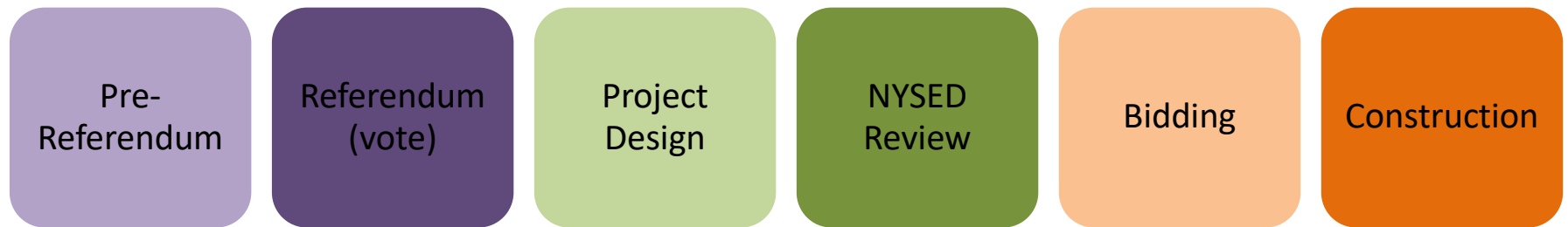

Overview of School Construction

July 23, 2019

king + king
ARCHITECTS



Capital Project Process - **Steps**

Step 1: Pre-Referendum

Pre-Referendum

Four horizontal lines of different colors (blue, orange, purple, and green) are positioned at the bottom of the slide, extending across the width of the page.

Why Now?

- Continue to be good stewards of your facilities
- Retiring debt
- Specific building systems are beyond their expected lifespan
- Proper planning & execution takes time!



Pre-Referendum

How do we start?

- Data Collection:
 - 2015/20 Building Condition Survey
 - Tours/Field Visits
 - End-user data/surveys
- Project Financials:
 - Retiring Debt
 - Maximum Cost Allowances / Building Aid
 - Capital Reserve
- Schedule:
 - Determine a VOTE date.



Pre-Referendum

What Now?

- A/E team will develop scope of work lists & graphics
- Committee to Prioritize:
 - Recommendation to BOE
 - BOE Decision
- Project Financials/Logistics:
 - Preliminary SED submission, if needed
 - SEQRA
 - Fiscal advisors (tax impact)
- Public Relations:
- VOTE!!



Pre-Referendum

Step 2: VOTE

Vote

The bottom of the slide features four horizontal lines of different colors: a blue line on the left, an orange line on the right, a dark red line on the right, and a green line on the right. These lines are stacked vertically and extend across the width of the slide.

Step 3: Project Design

Vote

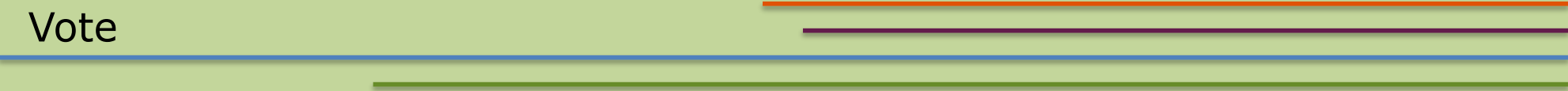
Four horizontal lines of different colors (blue, green, purple, orange) are positioned at the bottom of the slide, extending across most of the width. The blue line is the longest and is on the left. The green line is shorter and starts further to the right. The purple line is shorter still and starts further to the right. The orange line is the shortest and starts furthest to the right.

What happens during Project Design?

- Creation of construction documents
 - Schematic Design (SD)
 - Design Development (DD)
 - Construction Documents (CD)

Meet with end-users

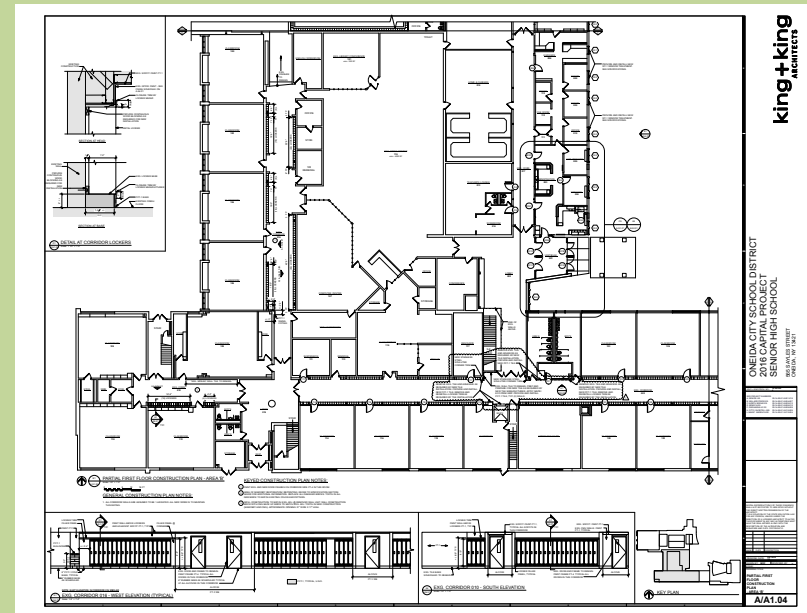

Project Design

Step 4: NYSED

NYSED Review & Approval

What happens at NYSED?

- Project submission to NYSED Facilities Planning for building permit.
- Architectural/Mechanical Review – Timing is critical!
- 3rd Party Review



NYSED Review & Approval

Step 5: Bidding

Bidding

The slide features four horizontal lines of different colors: a blue line on the left, a green line extending from the blue line towards the right, a purple line extending further right, and an orange line extending to the far right edge of the slide.

What happens during the Bidding Phase?

- Public bid of contracts, including multiple prime contracts as required by General Municipal Law.
- Review and qualification of bids.
- Award of contracts



Bidding

Step 6: Construction

Construction Administration



What happens during the Construction Phase?

- Ensure student & staff safety
- Phasing of work, as necessary
- Substantial Completion
- Project Close-out
- Final Cost Reporting



Construction Administration
